

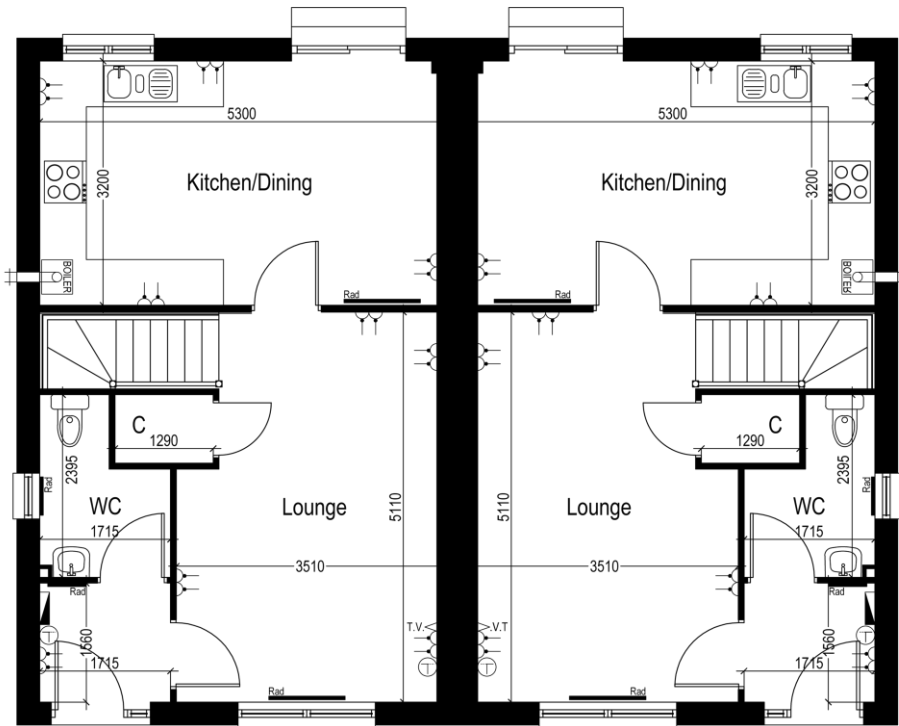

# The Maltings, Muir of Ord

## NEVIS (M TYPE)



Ground Floor Plan  
44.5sqm

	Approx (mm)
LOUNGE	3510 x 5110
KITCHEN/DINING	3200 x 5300
GRD FLR TOILET (incl cupboard)	1715 x 2935
ENTRANCE HALL	1560 x 1715



First Floor Plan  
44.5sqm

	Approx (mm)
BEDROOM 1	3110 x 3215
ENSUITE	2115 x 2350
BEDROOM 2	2830 x 3050
BEDROOM 3	2395 x 3050
BATHROOM	1730 x 2015

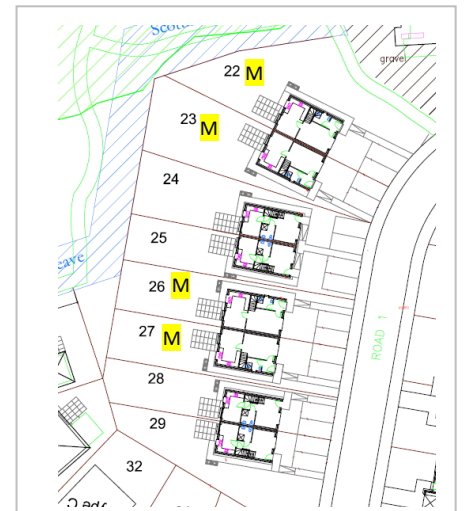

All images for illustrative purposes only. The floor measurements are given as an indication of the approximate dimensions of the house. Design and/or dimensions may be altered if necessary to satisfy Building and NHBC regulations or standards.